

D-NAMIC

92 Shore A
+90°C
-40°C

INOX

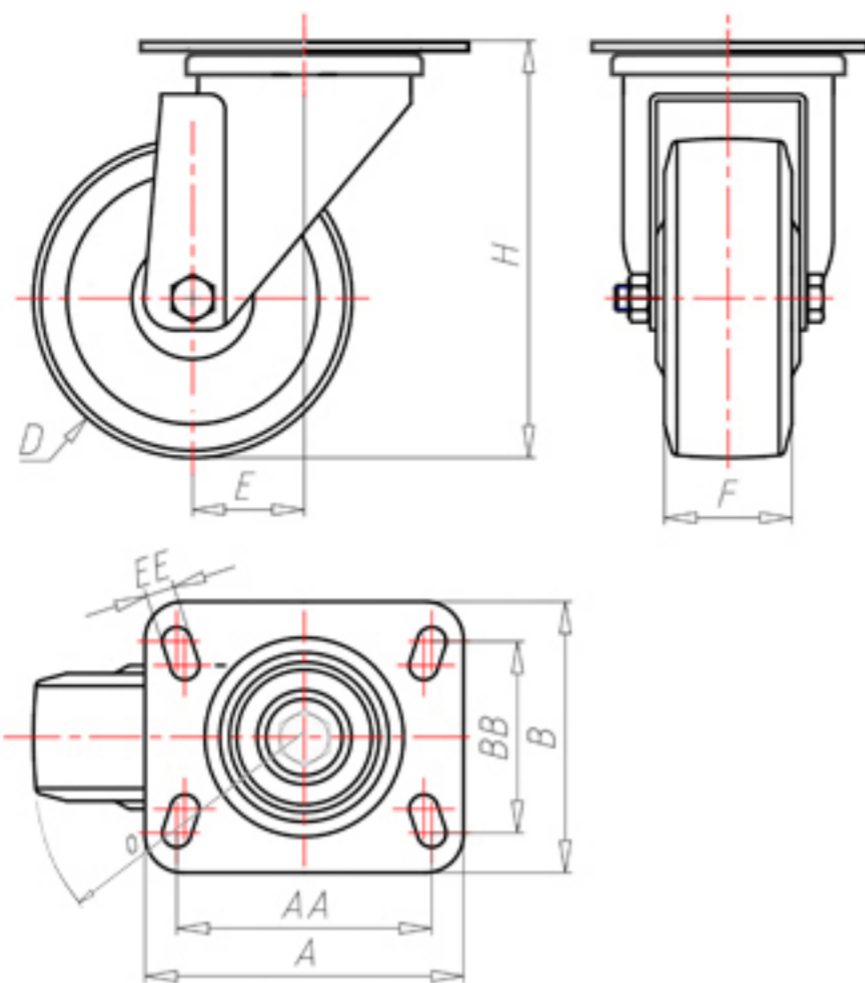

	D	200
	F	50
	H	235
	AxB	135x110
	AAxBB	105x80
	EE	11
	E	56
	O	152
	LC	500



Code for plain bore wheel

XNGX20060P



Code for wheel with Inox roller bearing

XNGX20060PRX



Code for wheel with double sealed ball bearing

XNGX200PC



Code for wheel with double sealed Inox ball bearing

XNGX200PCX

