

D-NAMIC

92 Shore A  
+90°C  
-40°C

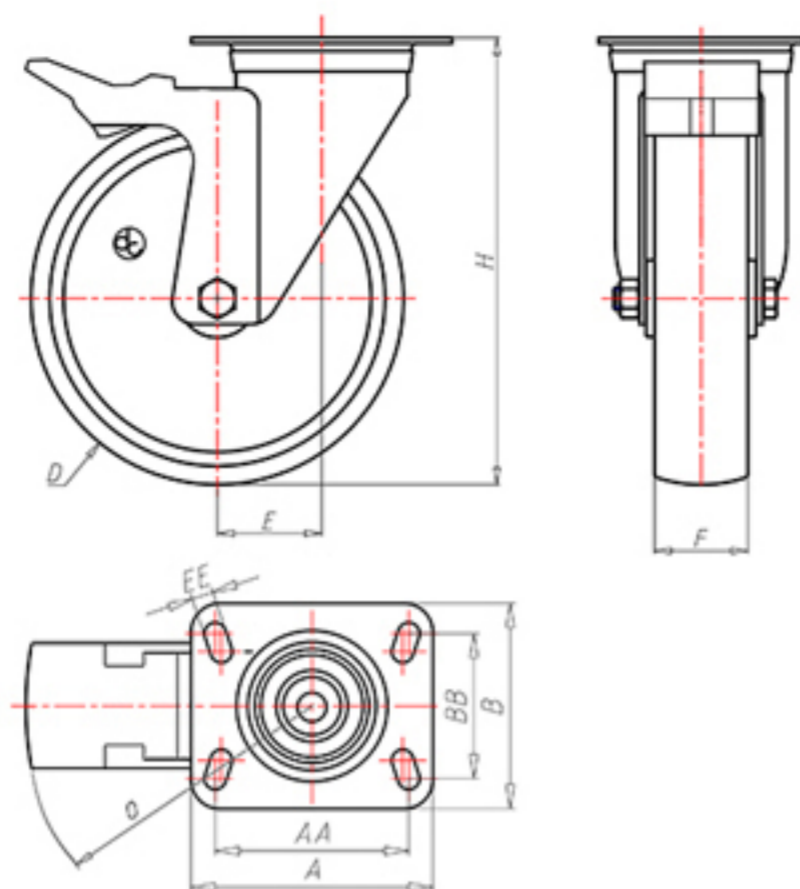

	D	200
	F	50
	H	232
	AxB	135x110
	AAxBB	105x80
	EE	11
	E	56
	O	167
	LC	400



Code for plain bore wheel

XNGZ20060FA



Code for wheel with roller bearing

XNGZ20060RFA



Code for wheel with double sealed ball bearing

XNGZ200CFA



Code for wheel with double sealed Inox ball bearing

-

